

Sink



- Your best choice if you are unsure of the original part
- Just look for the UNIVERSAL "FIT-ALL™" on package as shown

Pop-up Drain Assembly

Purpose...

- Connects bathroom sink to drain line

Tools required...

- Needle Nose Pliers
- Slip-Joint Pliers
- Plumber's Putty

When repairing...

- Always replace washers and gaskets.

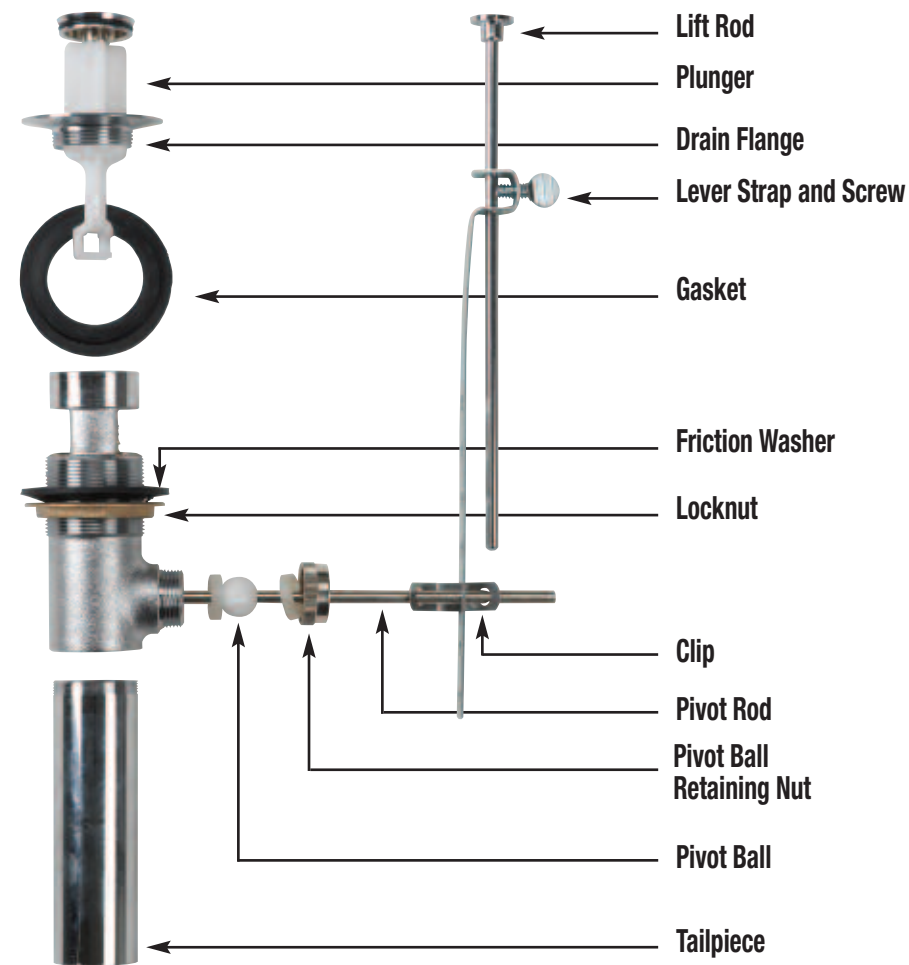

Sink Strainer Assembly

Purpose...

- Connects kitchen sink to drain line

Tools required...

- Slip-Joint pliers
- Hammer
- Basket Strainer Wrench
- Plastic Putty Knife
- Mini Hacksaw
- Screwdriver
- Plumber's Putty

When repairing...

- Always replace washers and gaskets.

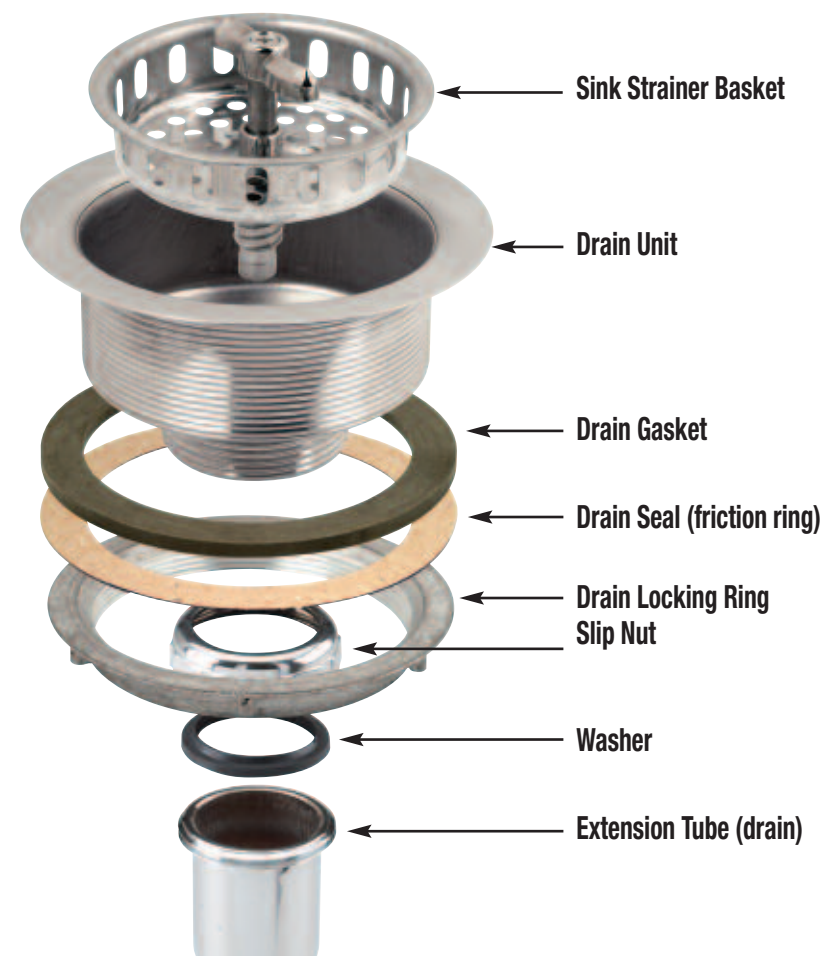

Kitchen Sink Strainers

M2210



Universal - Your best choice if you are unsure of correct fit

M2215



Plastic Clip

M2225



Twist Clawfoot

M2220



Metal Post

M2212



Metal Clip

M2211



4 Post